

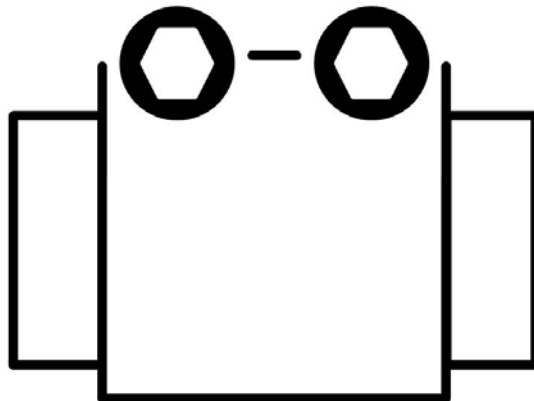

10. Straub® Couplings

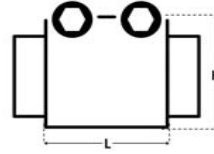



10. Straub® couplings

Product name	Description	L x H (mm)	Δ P. Bar max	T min/max °C	Material	Dn	Art.no. ITS	Picture
ITS Straub FP Grip-L *	Coupling Flame Stop Range 59,7 till 60,9mm	46 x 43	46	Liner specification	stainless Steel 30	26,9	366050	
	NBR	46 x 47	42	Liner specification	stainless Steel 30	30,0	366051	
		46 x 51	38	Liner specification	stainless Steel 30	33,7	366052	
		61 x 57	33	Liner specification	stainless Steel 30	38,0	366053	
		61 x 62	30	Liner specification	stainless Steel 30	42,4	366054	
		61 x 64	33	Liner specification	stainless Steel 30	44,5	366055	
		61 x 67	30	Liner specification	stainless Steel 30	48,3	366056	
		76 x 76	20	Liner specification	stainless Steel 30	54,0	366057	
		76 x 76	18	Liner specification	stainless Steel 30	57,0	366058	
		76 x 79	22	Liner specification	stainless Steel 30	60,3	366059	
		95 x 98	31	Liner specification	stainless Steel 30	76,1	366060	
		95 x 112	26	Liner specification	stainless Steel 30	84,0	366061	
		95 x 111	22	Liner specification	stainless Steel 30	88,9	366062	
		95 x 132	23	Liner specification	stainless Steel 30	104,0	366063	
		95 x 130	21	Liner specification	stainless Steel 30	108,0	366064	
		95 x 136	16	Liner specification	stainless Steel 30	114,3	366065	
		110 x 153	19	Liner specification	stainless Steel 30	129,0	366066	
		110 x 157	19	Liner specification	stainless Steel 30	133,0	366067	
		110 x 164	16	Liner specification	stainless Steel 30	139,7	366068	
	Bigger measurements on request	110 x 184	16	Liner specification	stainless Steel 30	154,0	366069	

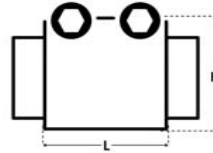

10. Straub® couplings

Product name	Description	L x H (mm)	Δ P. Bar max	T min/max °C	Material	Dn	Art.no. ITS	Picture
ITS Straub Grip-L W4 *		67 x 47	67	Liner specification	stainless Steel 30	26,9	366090	
		67 x 52	62	Liner specification	stainless Steel 30	30,0	366091	
		61 x 58	58	Liner specification	stainless Steel 30	33,7	366092	
		61 x 62	53	Liner specification	stainless Steel 30	38,0	366093	
		61 x 64	48	Liner specification	stainless Steel 30	42,4	366094	
	Coupling Range 44.0 tot 45.0 mm	61 x 68	44	Liner specification	stainless Steel 30	44,5	366095	
	Coupling Range 47.8 tot 48.8 mm	77 x 74	39	Liner specification	stainless Steel 30	48,3	366096	
	Coupling Range 53.5 tot 54.5 mm	77 x 77	37	Liner specification	stainless Steel 30	54,0	366097	
	Coupling Range 56.4 tot 57.6 mm	77 x 82	37	Liner specification	stainless Steel 30	57,0	366098	
	Coupling Range 59,7 tot 60,9 mm	94 x 100	56	Liner specification	stainless Steel 30	60,3	366099	
		94 x 112	45	Liner specification	stainless Steel 30	76,1	366100	
		94 x 117	41	Liner specification	stainless Steel 30	84,0	366101	
	Coupling Range 88 tot 89,8 mm	94 x 133	37	Liner specification	stainless Steel 30	88,9	366102	
		94 x 133	35	Liner specification	stainless Steel 30	104,0	366103	
		94 x 139	34	Liner specification	stainless Steel 30	108,0	366104	
		108 x 160	33	Liner specification	stainless Steel 30	114,3	366105	
		108 x 160	33	Liner specification	stainless Steel 30	129,0	366106	
		109 x 168	32	Liner specification	stainless Steel 30	133,0	366107	
		109 x 186	32	Liner specification	stainless Steel 30	139,7	366108	
	Bigger measurements on request	109 x 187	31	Liner specification	stainless Steel 30	154,0	366109	